

PHLASTER

HOLSTERS & ACCESSORIES MANUAL

TABLE OF CONTENTS

- 1. WARNINGS AND DISCLAIMERS**
- 2. GRIPHOOK INSTALLATION**
- 3. SOFT LOOP INSTALLATION & OPERATION**
- 4. TUCKSTRUT INSTALLATION**
- 5. MODWING INSTALLATION**
- 6. RETENTION ADJUSTMENT**
- 7. IWB FLOODLIGHT ADJUSTMENT**

Thank you for choosing PHLster!

The safe use and long life of your holster depends on reading, understanding, and applying the contents of this manual. Please read, understand, and adhere to the guidelines of this manual before using your holster.

Improper holster use can result in serious injury or death. Read and understand this manual, as well as the manual for your gun, prior to use.

If your holster is broken, defective, or incorrect for your gun, discontinue use IMMEDIATELY and contact us at info@phlsterholsters.com.

We stand by to assist you with any questions you may have about the product, and provide any assistance you may need. Do not hesitate to contact us, should you require service.

Inside the waistband and low-profile concealment holsters require extreme care when holstering the gun, due to their proximity to the body and their potential interaction with your clothing. Do not use or carry with a low-profile concealment holster without prior training and instruction from a qualified professional firearms instructor.

Prior to use, test fit and adjust your holster with an unloaded gun.

Unless explicitly stated, the holsters are not interchangeable. Do not use your holster with a gun unless it's explicitly on the approved fit list of guns for that holster. For example, do not use CZ or P80 guns with your Glock-specific holster. Review the holster product page at www.PHLsterHolsters.com for the comprehensive fit list for your holster.

Light-bearing holsters are light-specific. Do not use your light bearing holster with any light other than the light for which the holster is approved.

Firearms which have been substantially modified from their stock configuration should not be used with these holsters. Any grip work which has significantly changed the shape or dimension of the frame or trigger guard, substantially oversized controls or levers, or excessively lightened triggers should not be used in these holsters

and could create an unsafe condition. When test fitting your holster with an unloaded gun, if you discover that an extended control, tall sight, frame modification, gun coating, or other customization causes an issue with holster fit, immediately discontinue use and contact us at info@phlsterholsters.com. Do not attempt to modify your holster or your gun to improve the fit.

Check the condition and tightness of all belt mounting hardware, fasteners, and adjusting screws prior to use, every day.

Apply thread locking compound (Blue Loctite 242 or similar) to screws and fasteners, once you've finalized your holster adjustments.

If your gun is equipped with a safety, always make sure that the safety is engaged when holstering your gun.

De-cock all double/single action guns before holstering.

Always keep your trigger finger as high and away from the trigger guard as possible when drawing or holstering your gun.

Always be sure to completely clear any garments from the mouth of the holster when holstering the gun. Never "speed-reholster," and always be sure that you can observe the holster and verify that it's clear of any foreign items or materials prior to holstering the gun.

Do not cut, heat, grind or modify the holster shell for any reason.

Do not expose your holster to excessive heat, including radiators, fireplaces, space heaters, and the hot trunk of a car.

The comfort and concealment characteristics of your holster will depend on the hardware adjustments outlined in this user manual. Adjusting the holster to yourself, and adjusting yourself to the holster will take time and is highly dependent on the individual. We are committed to your satisfaction and will be happy to assist you in this process.

With proper care, your holster will last many years. However, anything man-made can wear out or break. The maintenance and longevity of this product is your responsibility. Always inspect your holster for proper fit, hardware integrity, and cracks in the shell prior to use. If your holster becomes unserviceable, do not attempt to make a repair.

If your holster becomes unserviceable, do not attempt to make a repair. Contact us immediately at info@phlsterholsters.com and we will be happy to provide any replacement parts you might need, including any and all hardware, and including the holster shell itself. Your holster has a comprehensive lifetime warranty, which we are happy to honor at any time.

GRIPHOOK INSTALLATION

GRIPHOOK INSTALLATION

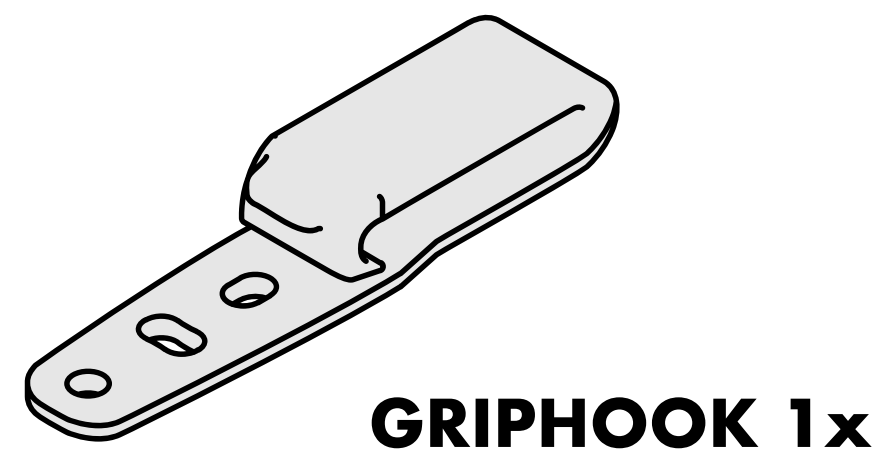

  **SCREW 2X**

  **RUBBER BUSHINGS 2X**

  **POST 2X**

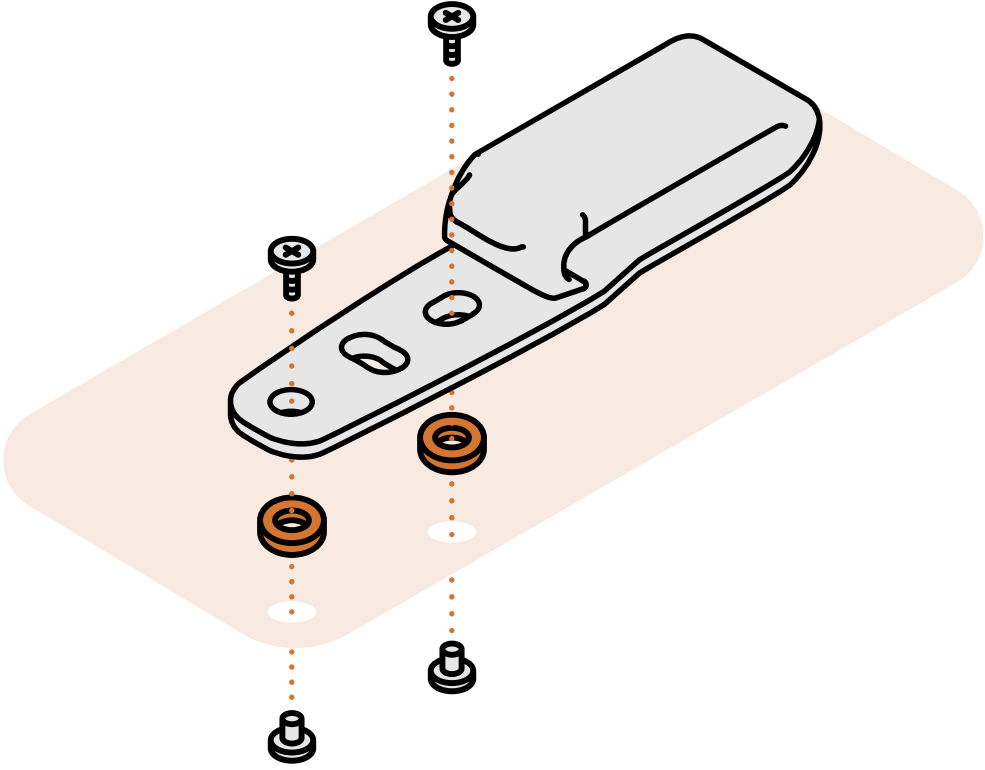

INSTRUCTIONS

Always install clips using two screws. Using a single screw will cause the clip to rotate and cause the hardware to come loose, creating a dangerous condition with the holster. Always install the **rubber bushings** between the holster and the clip. The rubber bushings should never be inside the holster or on the face of the clip.

SOFT LOOP INSTALLATION & OPERATION

SOFT LOOP INSTALLATION & OPERATION

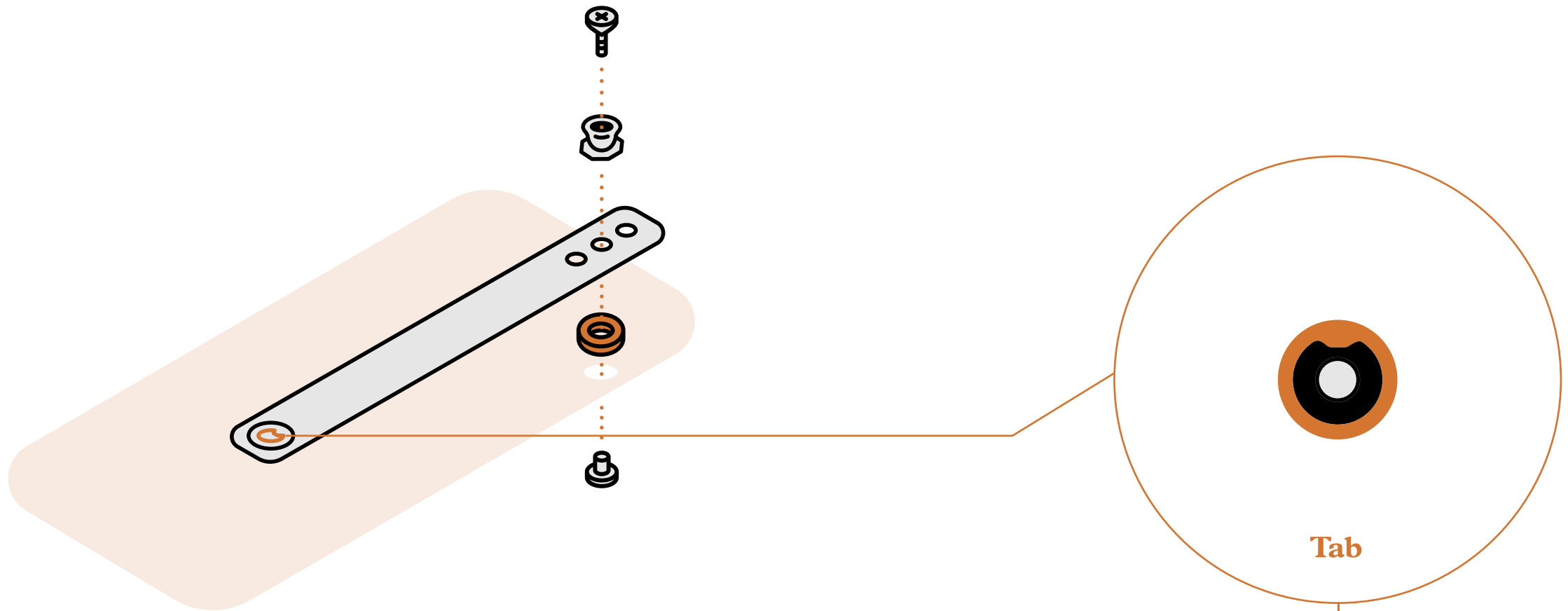
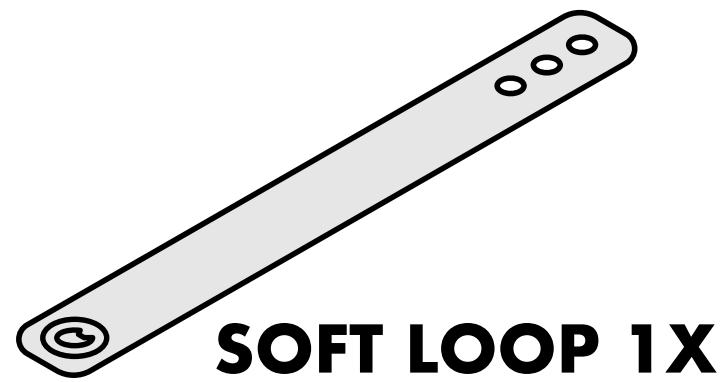

INSTRUCTIONS

The biothane soft loops on your holster are secure and adjustable and your holster will work best with the loop adjusted to fit your belt. Shorten the effective length of the loop by installing the male hardware through a different hole in the loop. Always put the **rubber bushing** between the body of the holster and the loop. The snaps are pull-the-dot directional snaps for maximum security and durability. The female portion of the snap has a **tab** which fits under the collar of the male snap stud. This requires that the **tab** fit under the **collar** to close the snap, and the snap will only fasten and open in one **direction**.

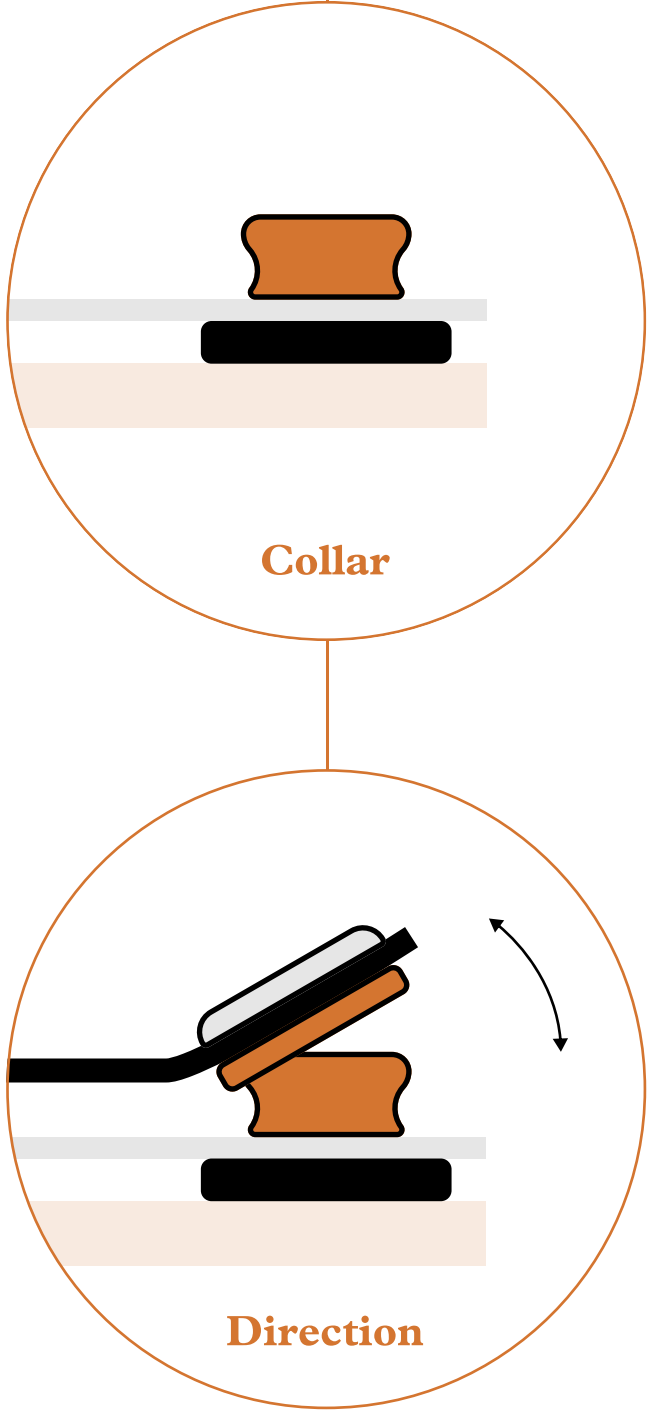

TUCKSTRUT INSTALLATION

TUCKSTRUT INSTALLATION

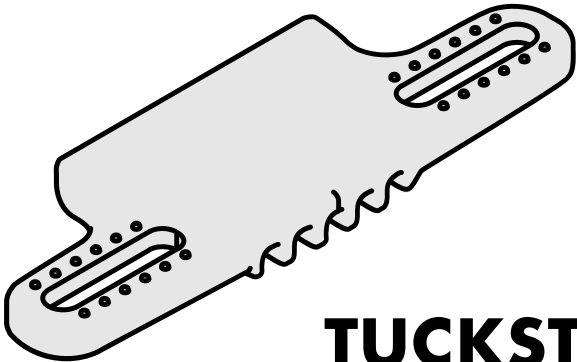

TUCKSTRUT 1X



SCREW 2X

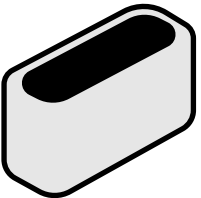

SPACER 1X

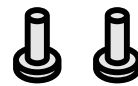

POST 2X

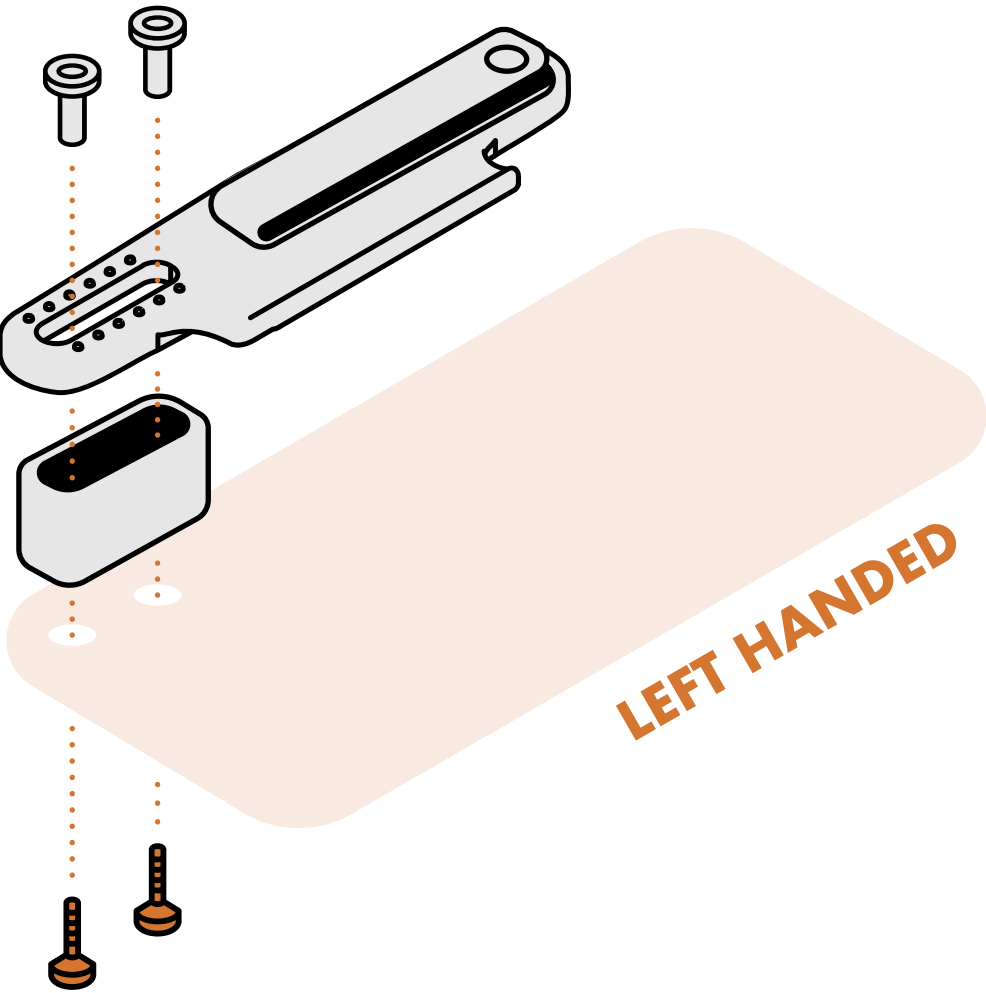
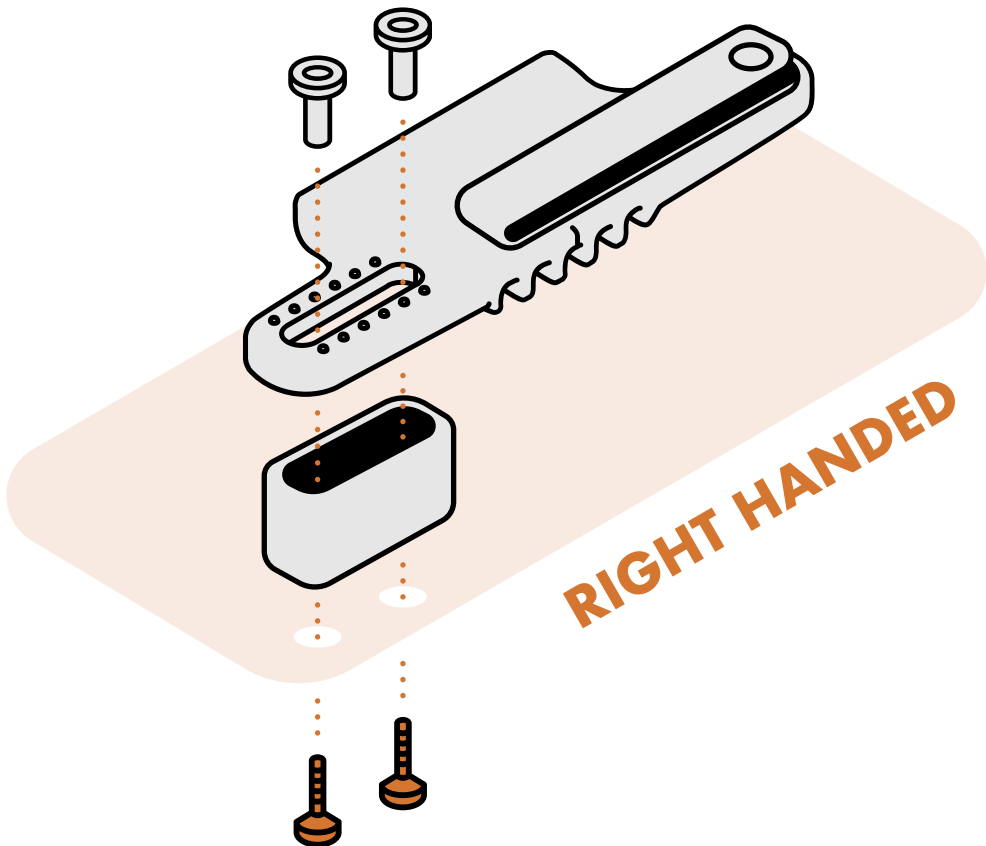

INSTRUCTIONS

The TuckStrut is a fully ambidextrous piece of hardware which provides grip rotation to the gun when the belt is tightened, and allows the shirt to tuck between the gun and the holster for increased concealment. To switch the TuckStrut from right to left handed, dismount the TuckStrut from the holster and install the loop on the opposite end of the strut, so the wing portion is now oriented to the left. Make sure that the **oval head screws** always go through the back of the holster and contact the metal eyelets, and the threaded posts go through the front of the TuckStrut. Installing the oval head screws through the face of the TuckStrut will damage the plastic and the strut will be less secure.

MODWING INSTALLATION

MODWING INSTALLATION

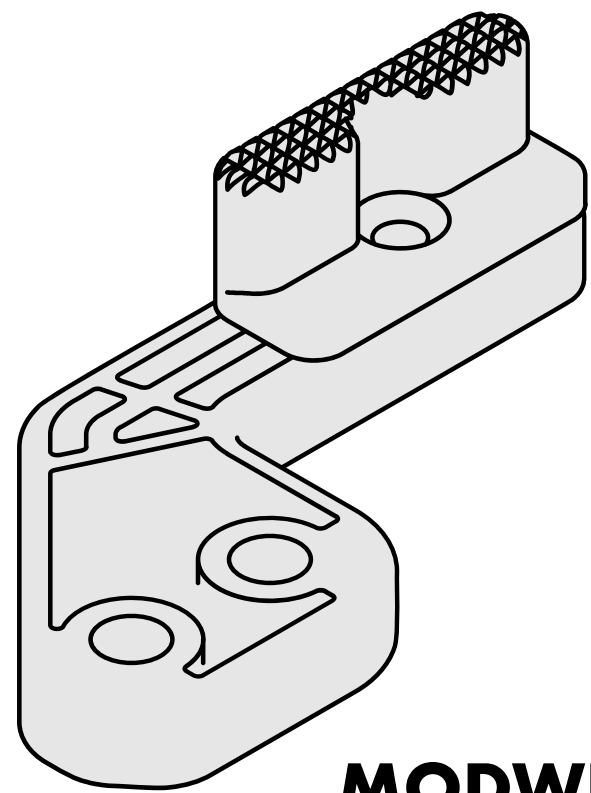

MODWING 1X



SCREW 2X

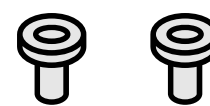

METAL EYELET 2x



POST 1X



HEX NUT 1x



TAPERED SCREW 1x

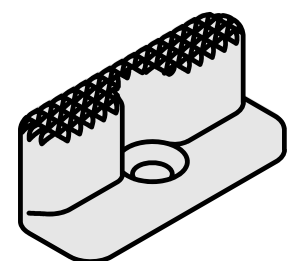

CLAW 2x (LARGE & SMALL)

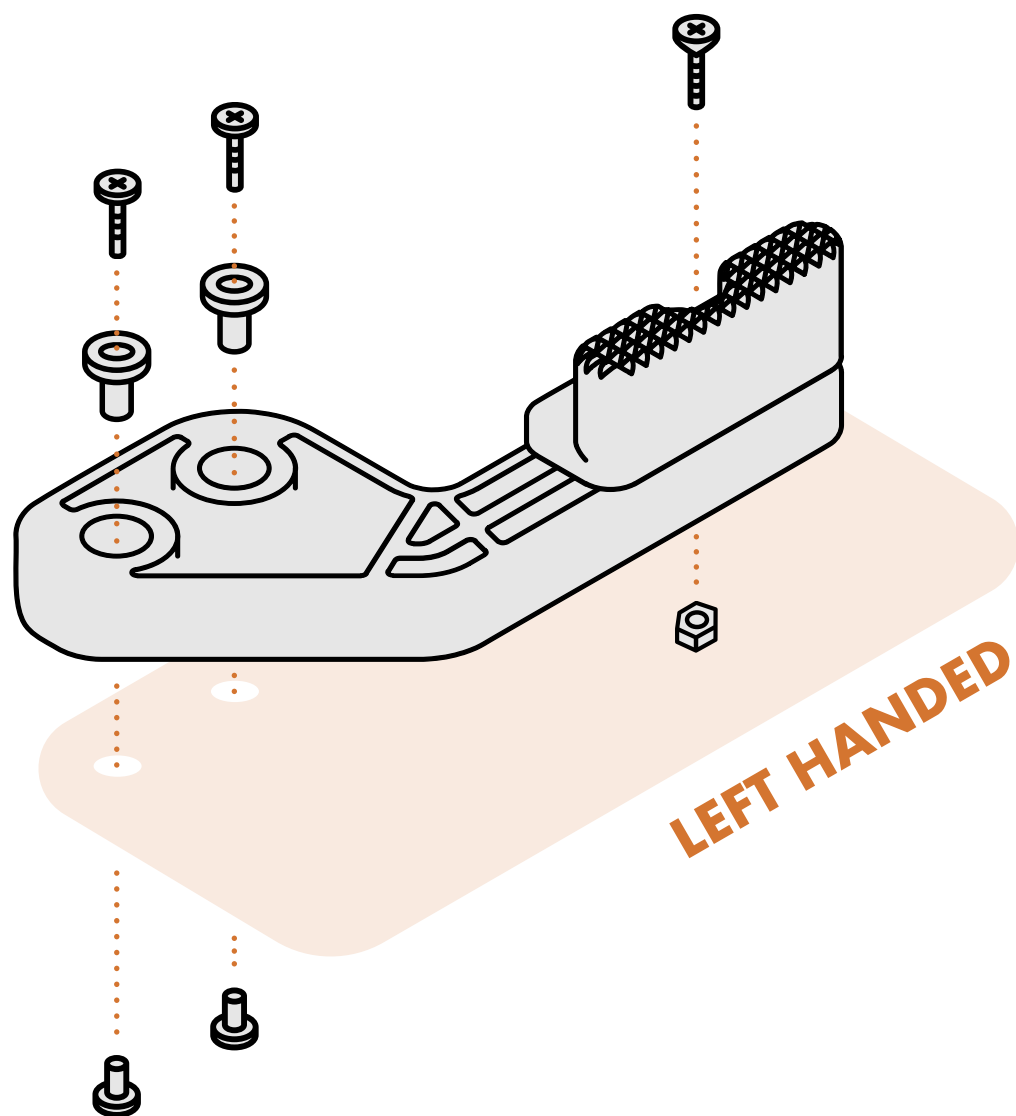
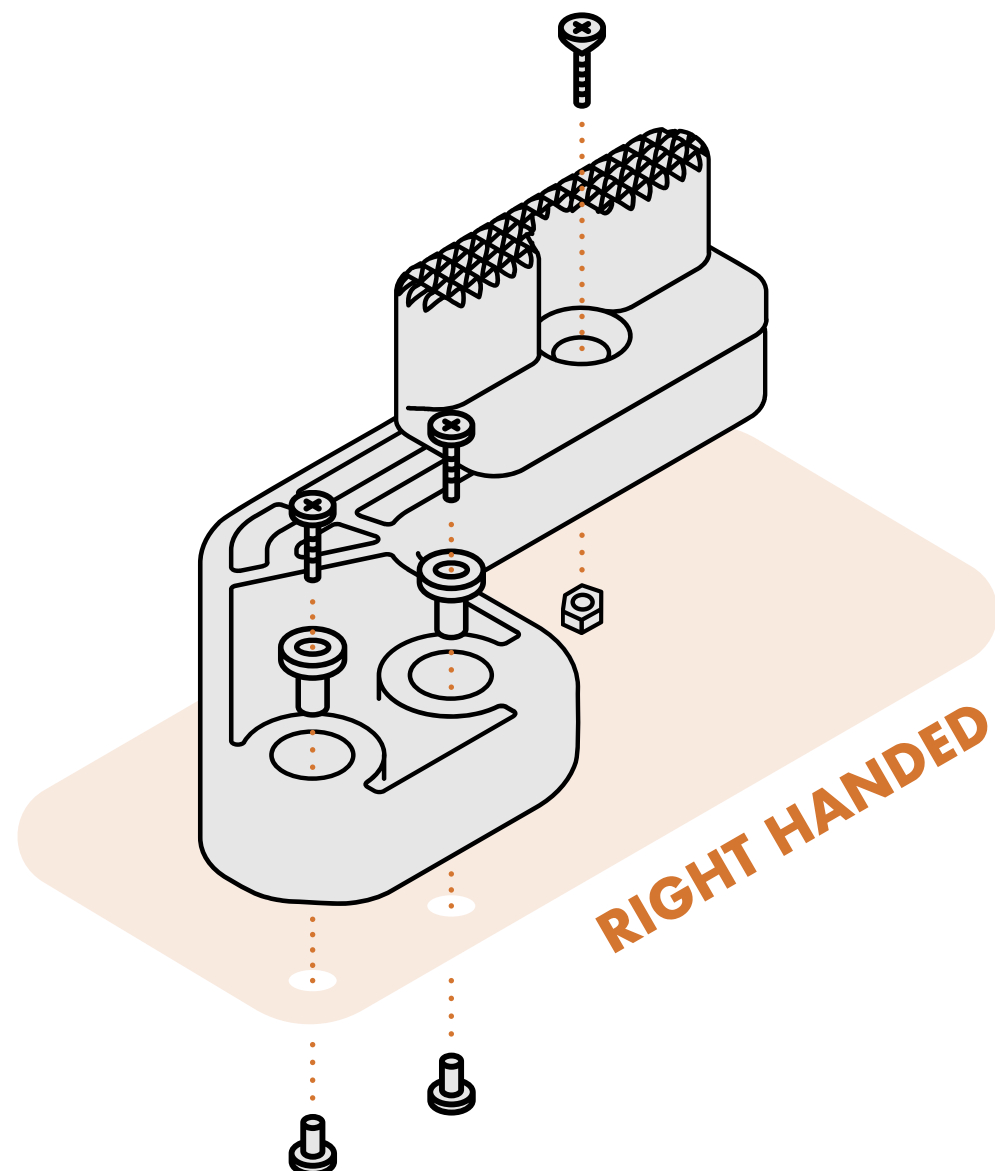

INSTRUCTIONS

The ModWing hardware provides adjustable grip rotation to reduce printing. It comes in light-bearing and non-light bearing configurations. Do not use non-light-bearing ModWings on light-bearing holsters. Modwings can be configured for right or left-hand carry. To configure for left-hand carry, dismount the ModWing from the holster. Remove the screw and nut in the center of the grip-rotation claw. Remove the metal eyelets from the mounting holes. Reinstall the grip-rotation claw on the opposite face of the ModWing. And place the metal eyelets on the same face of the wing as the grip-rotation claw.

On light bearing ModWings, always put the oval head screws through the ModWing and the threaded posts through the holster, as shown. On NON-light bearing ModWings, always put the oval head screws through the holster eyelets and the threaded posts through the ModWing.

To adjust the degree of grip rotation, and to press the gun into the body to a lesser or greater degree, simply swap out the grip rotation claw for the larger or smaller insert.

RETENTION ADJUSTMENT

RETENTION ADJUSTMENT



YES

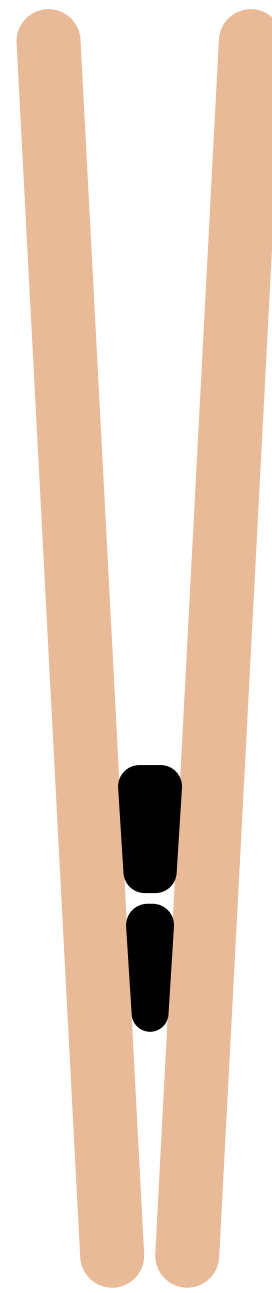

NO

INSTRUCTIONS

Our light-bearing holsters feature adjustable retention. Increase the friction fit by tightening the retention screws. Always tighten these screws evenly and equally. Do not tighten one screw more than the other. They work as a pair and uneven tightening can damage the holster and cause retention problems.

IWB FLOODLIGHT ADJUSTMENT

IWB FLOODLIGHT ADJUSTMENT

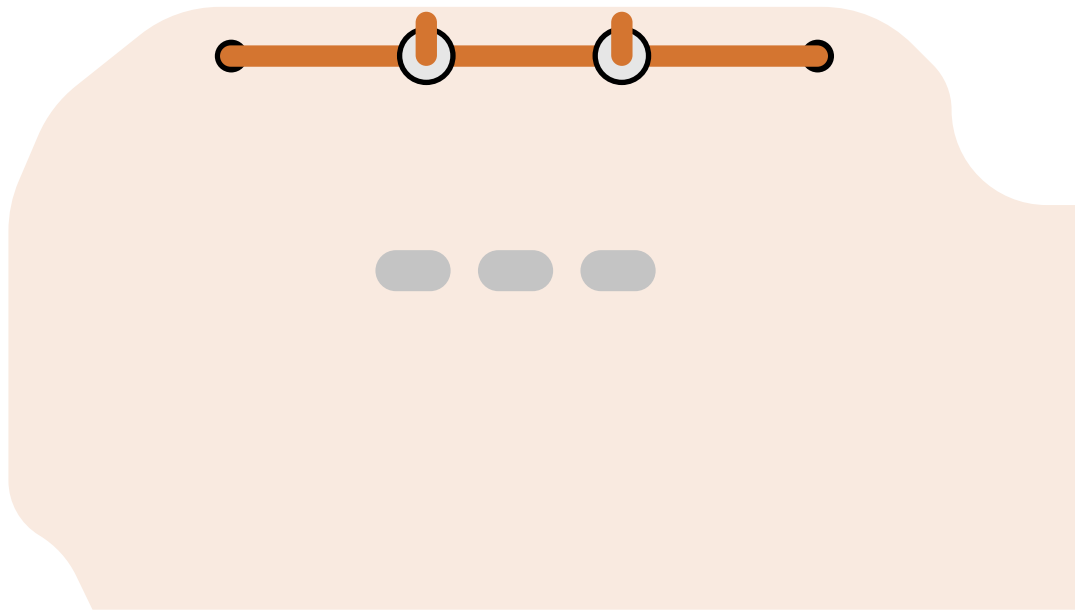
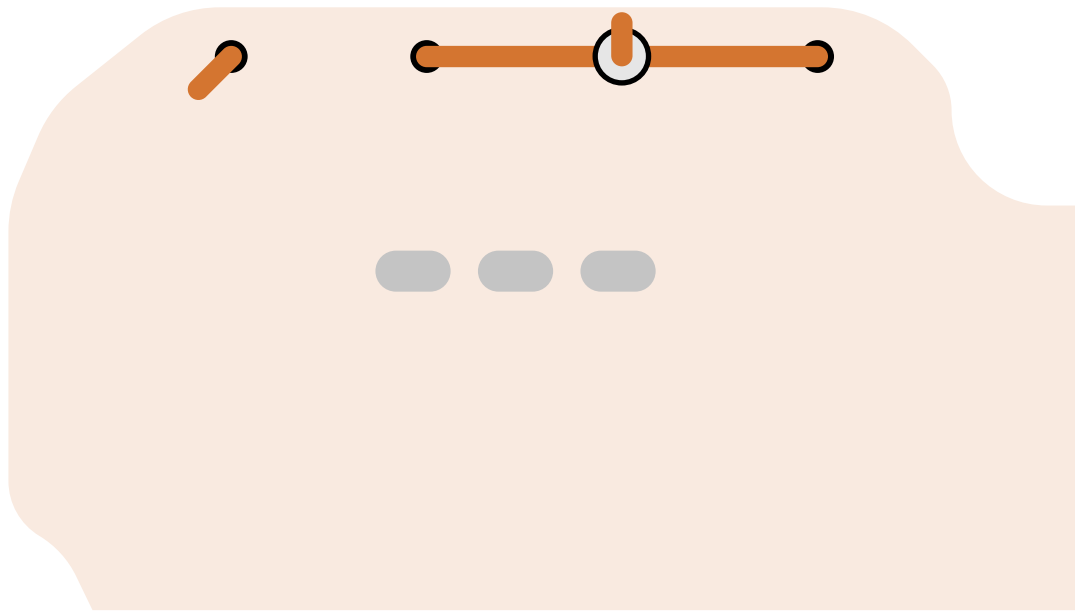
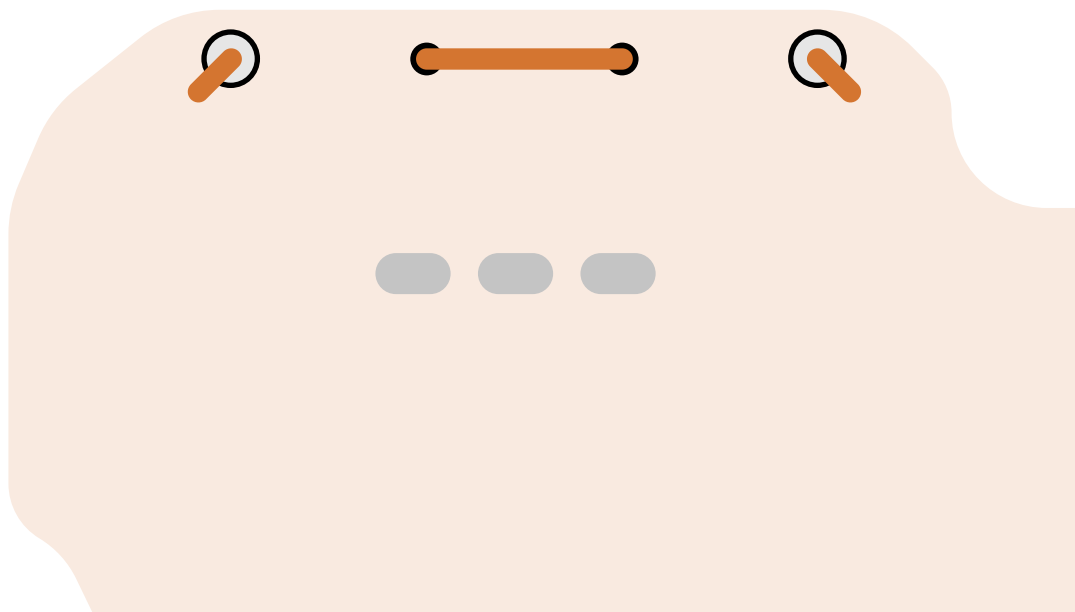

INSTRUCTIONS

To adjust the slide tension to fit your specific gun, pull the knotted shock cord end and washer through the center loop of the shock cord, on the back of the holster. For increased tightness, pull the other end through the same loop.

WWW.PHLSTERHOLSTERS.COM
INFO@PHLSTERHOLSTERS.COM